

Sea Link

Volume 6: Environmental Statement

Document: 6.4.2.2.I

Part 2 Suffolk

Chapter 2 Appendix 2.2.I

Nighttime Bat Walkover and Static Detector Survey Report – Figures Part 2 of 4

Planning Inspectorate Reference: EN020026

Version: A

March 2025

Infrastructure Planning (Applications: Prescribed Forms and Procedure)
Regulations 2009 Regulation 5(2)(a)

Contents

Application Document 6.4.2.2.I Nighttime Bat Walkover and Static Detector Survey Report – Figures Part 2 of 4

Application Document 6.4.2.2.I.2 Suffolk Nighttime Bat Walkover - August 2023

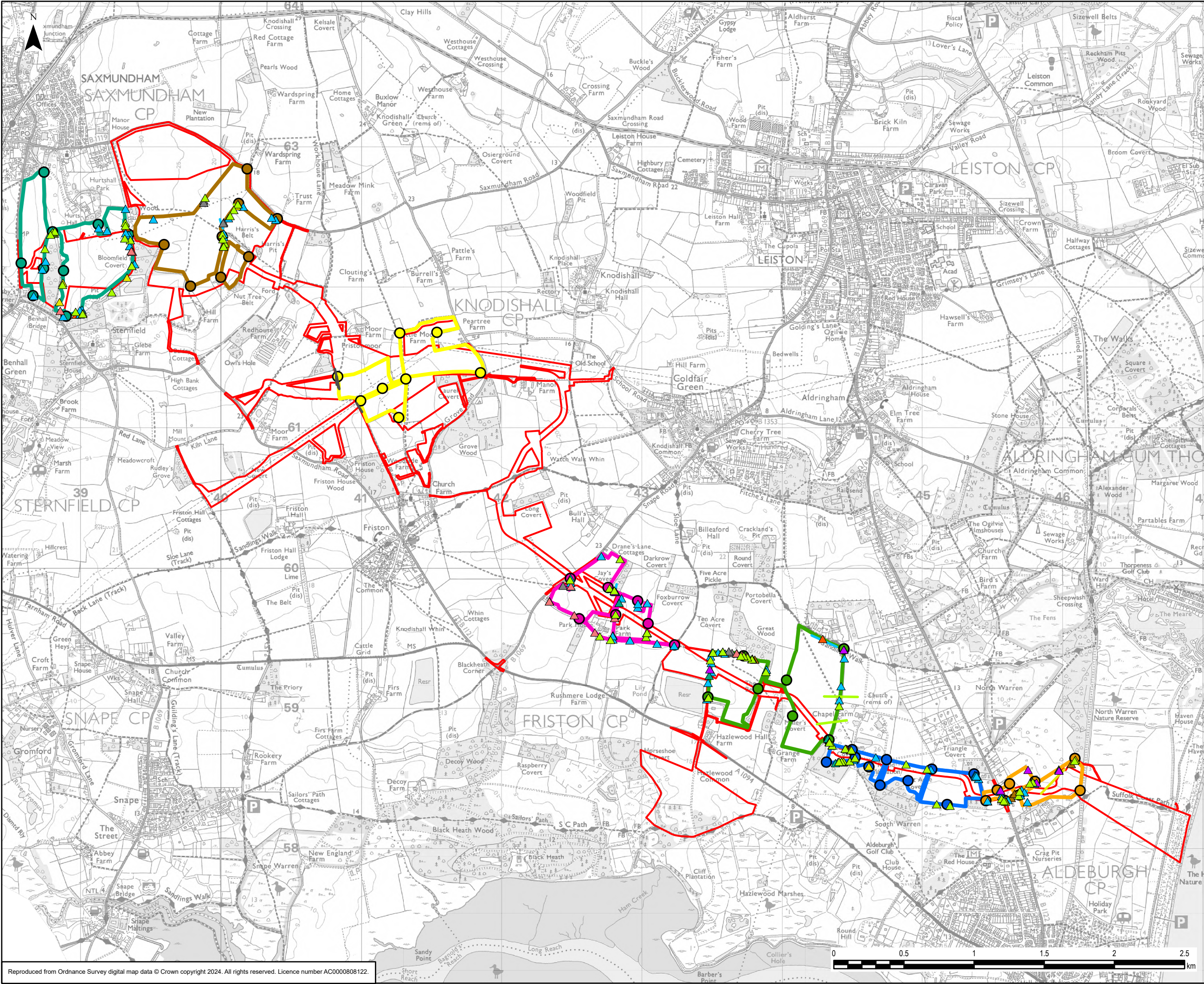

Legend

Suffolk Onshore Scheme Boundary

Transect 1 Point

Transect 1 Line

Transect 2 Point

Transect 2 Line

Transect 3 Point

Transect 3 Line

Transect 4 Point

Transect 4 Line

Transect 6 Point

Transect 6 Line

Transect 8 Point

Transect 8 Line

Transect 9 Point

Transect 9 Line

Bat Activity - Point

Barbastelle

Brown long-eared

Common pipistrelle

Leisler's Bat

Myotis species

Noctule

Pipistrelle species

Serotine

Soprano pipistrelle

Bat Activity - Line

Common pipistrelle

Noctule

Soprano pipistrelle

Bat species

0	28/01/2025	ENVIRONMENTAL STATEMENT	EB	DF	RW
Rev	Date	Description	GIS	Chk	App

nationalgrid

Scheme:SEA LINK

Document Title:SUFFOLK NIGHTTIME BAT WALKOVER - AUGUST 2023 OVERVIEW

Creator:EB	Date:28/01/2025	Checker:DF	Date:28/01/2025	Approver:RW	Date:28/01/2025
Document Ref:FIGURE 6.4.2.2.1.2	Scale:1:25,000	Format:A3	Sheets:1	Rev:0	

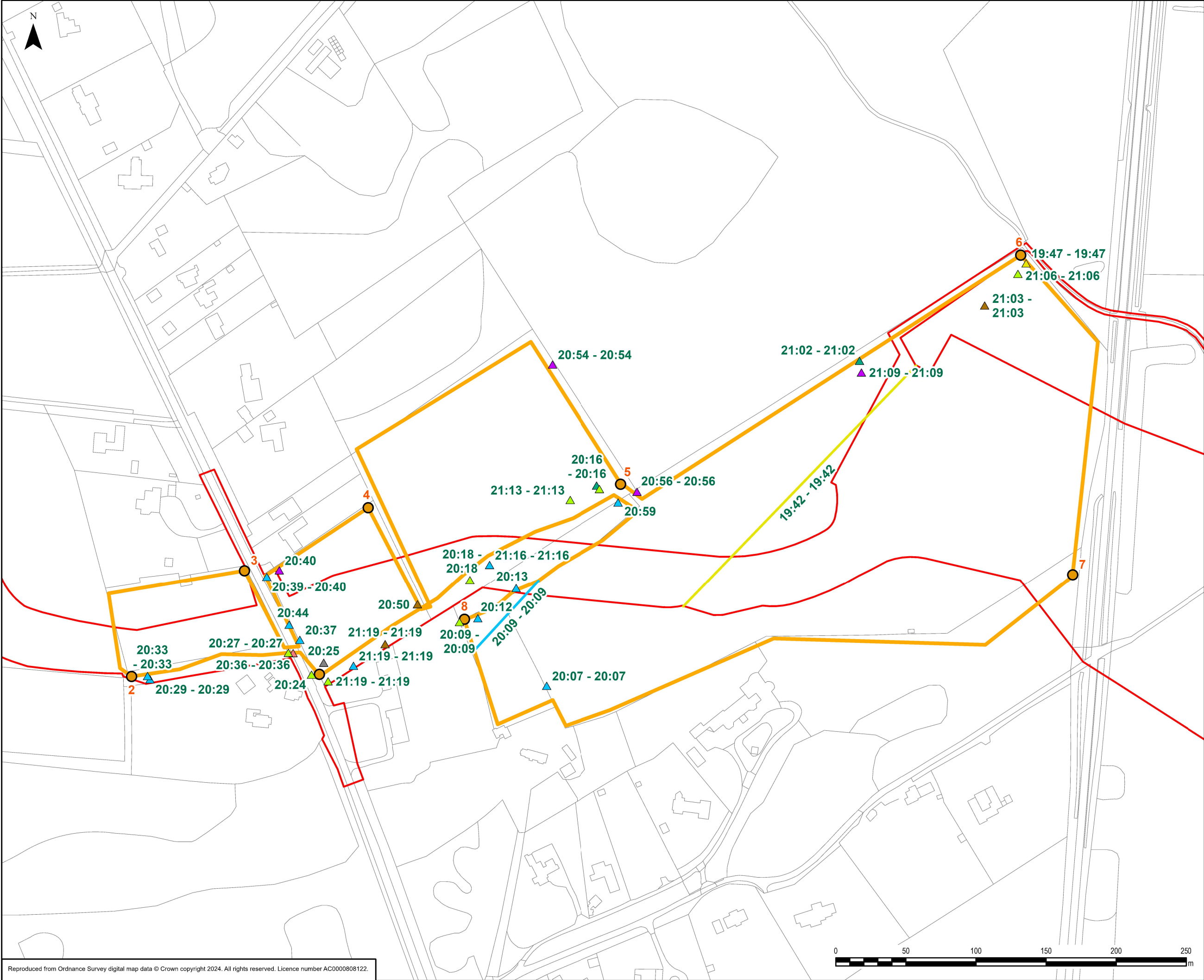

- Legend**
- Suffolk Onshore Scheme Boundary
 - Transect 1 Point
 - Transect 1 Line
 - Bat Activity - Point
 - Brown long-eared
 - Common pipistrelle
 - Leisler's Bat
 - Myotis species
 - Noctule
 - Pipistrelle species
 - Serotine
 - Soprano pipistrelle
 - Bat Activity - Line
 - Common pipistrelle
 - Noctule

0	21/01/2025	ENVIRONMENTAL STATEMENT	EB	DF	RW
Rev	Date	Description	GIS	Chk	App
nationalgrid					
Scheme: SEA LINK					
Document Title: SUFFOLK NIGHTTIME BAT WALKOVER - AUGUST 2023 TRANSECT 1					
Creator: EB	Date: 21/01/2025	Checker: DF	Date: 21/01/2025	Approver: RW	Date: 21/01/2025
Document Ref: FIGURE 6.4.2.2.1.2	Scale: 1:2,500	Format: A3	Sheets: 1	Rev: 0	

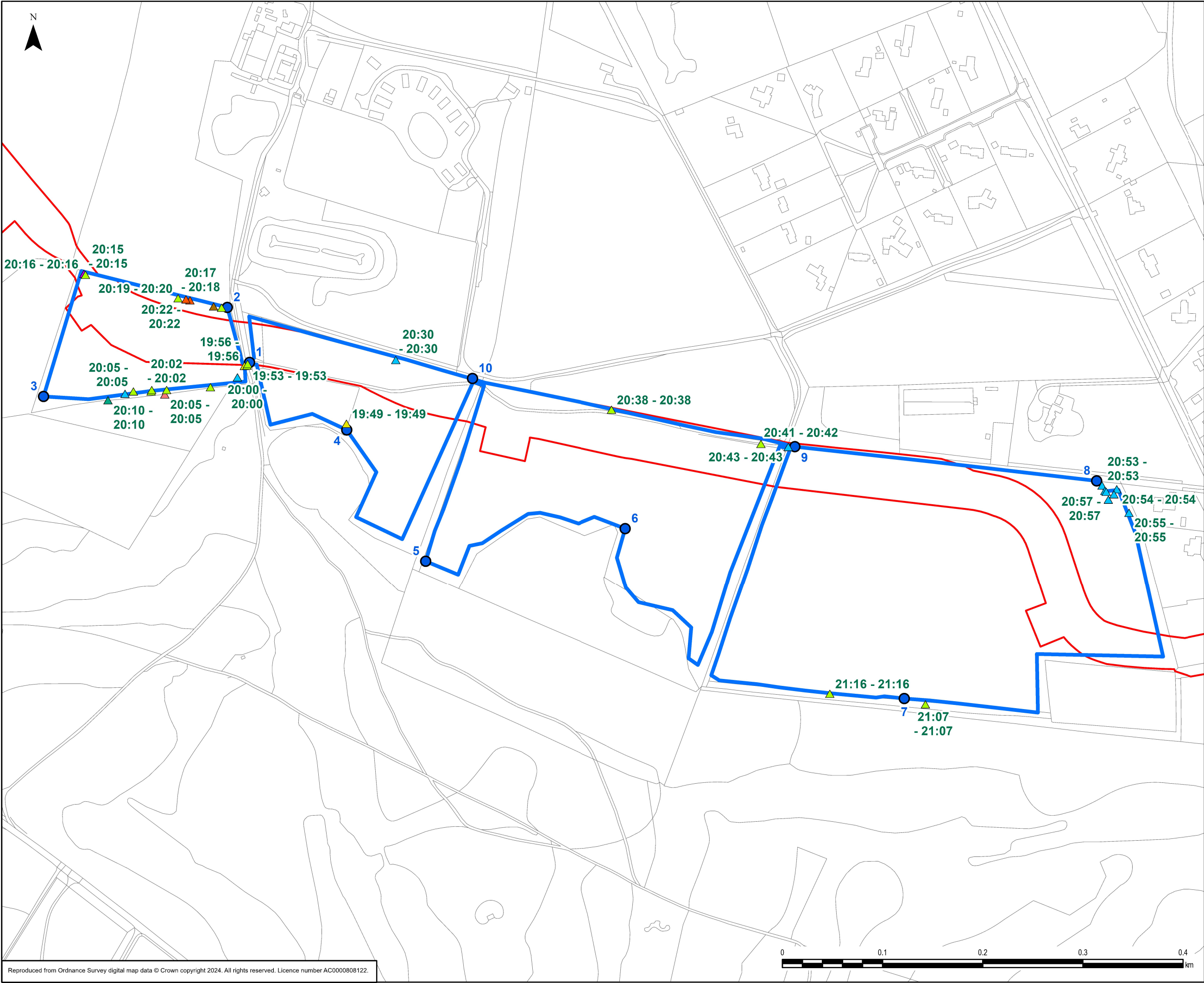

Legend

Suffolk Onshore Scheme Boundary

Transect 2 Point

Transect 2 Line

Bat Activity - Point

Barbastelle

Brown long-eared

Common pipistrelle

Leisler's Bat

Myotis species

Noctule

Serotine

Soprano pipistrelle

0	21/01/2025	ENVIRONMENTAL STATEMENT	EB	DF	RW
Rev	Date	Description	GIS	Chk	App
nationalgrid					
Scheme: SEA LINK					
Document Title: SUFFOLK NIGHTTIME BAT WALKOVER - AUGUST 2023 TRANSECT 2					
Creator: EB	Date: 21/01/2025	Checker: DF	Date: 21/01/2025	Approver: RW	Date: 21/01/2025
Document Ref: FIGURE 6.4.2.2.1.2	Scale: 1:3,500	Format: A3	Sheets: 1	Rev: 0	

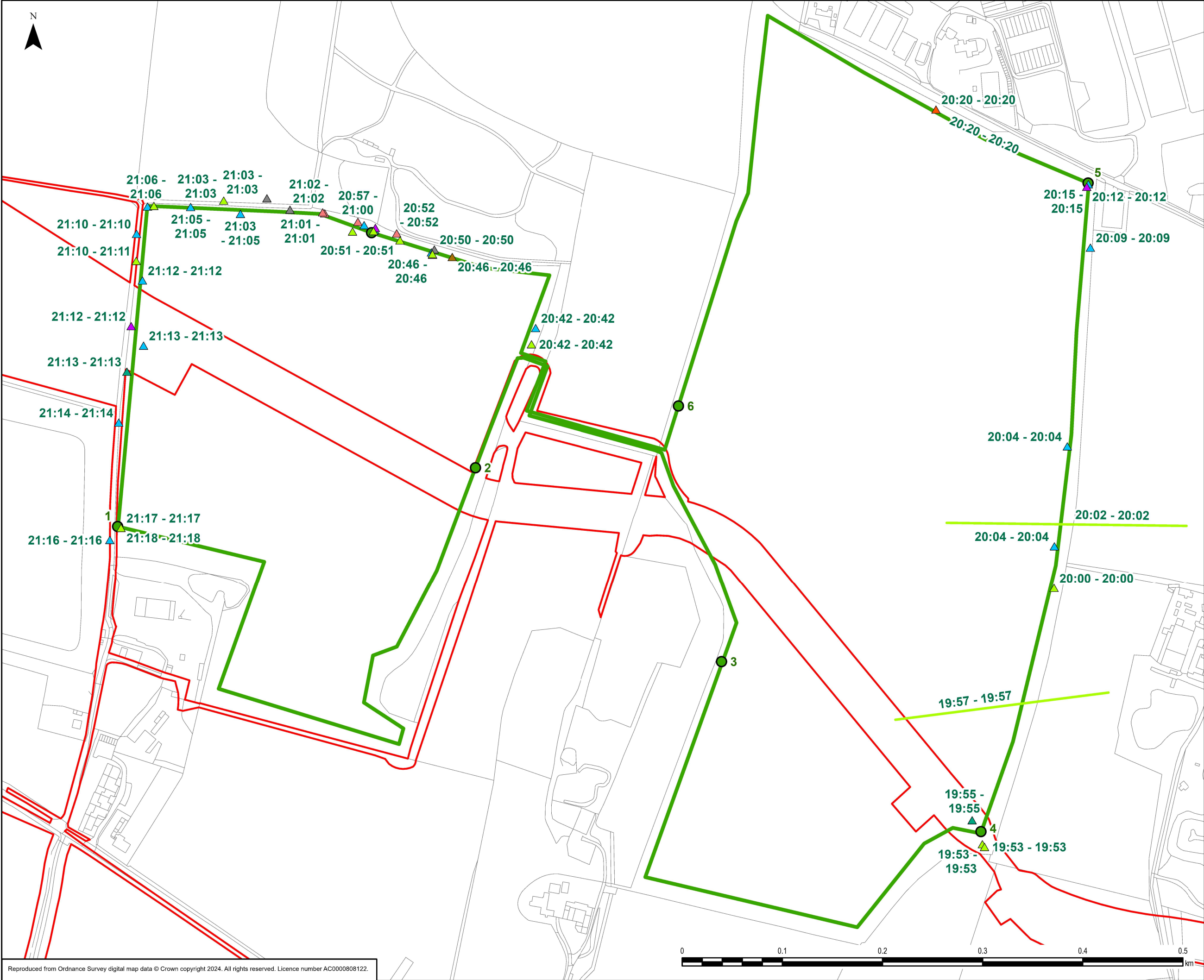

Legend

Suffolk Onshore Scheme Boundary

Transect 3 Point

Transect 3 Line

Bat Activity - Point

Barbastelle

Brown long-eared

Common pipistrelle

Leisler's Bat

Myotis species

Pipistrelle species

Serotine

Soprano pipistrelle

Bat Activity - Line

Soprano pipistrelle

0	21/01/2025	ENVIRONMENTAL STATEMENT	EB	DF	RW
Rev	Date	Description	GIS	Chk	App
nationalgrid					
Scheme: SEA LINK					
Document Title: SUFFOLK NIGHTTIME BAT WALKOVER - AUGUST 2023 TRANSECT 3					
Creator: EB	Date: 21/01/2025	Checker: DF	Date: 21/01/2025	Approver: RW	Date: 21/01/2025
Document Ref: FIGURE 6.4.2.2.1.2	Scale: 1:3,500	Format: A3	Sheets: 1	Rev: 0	

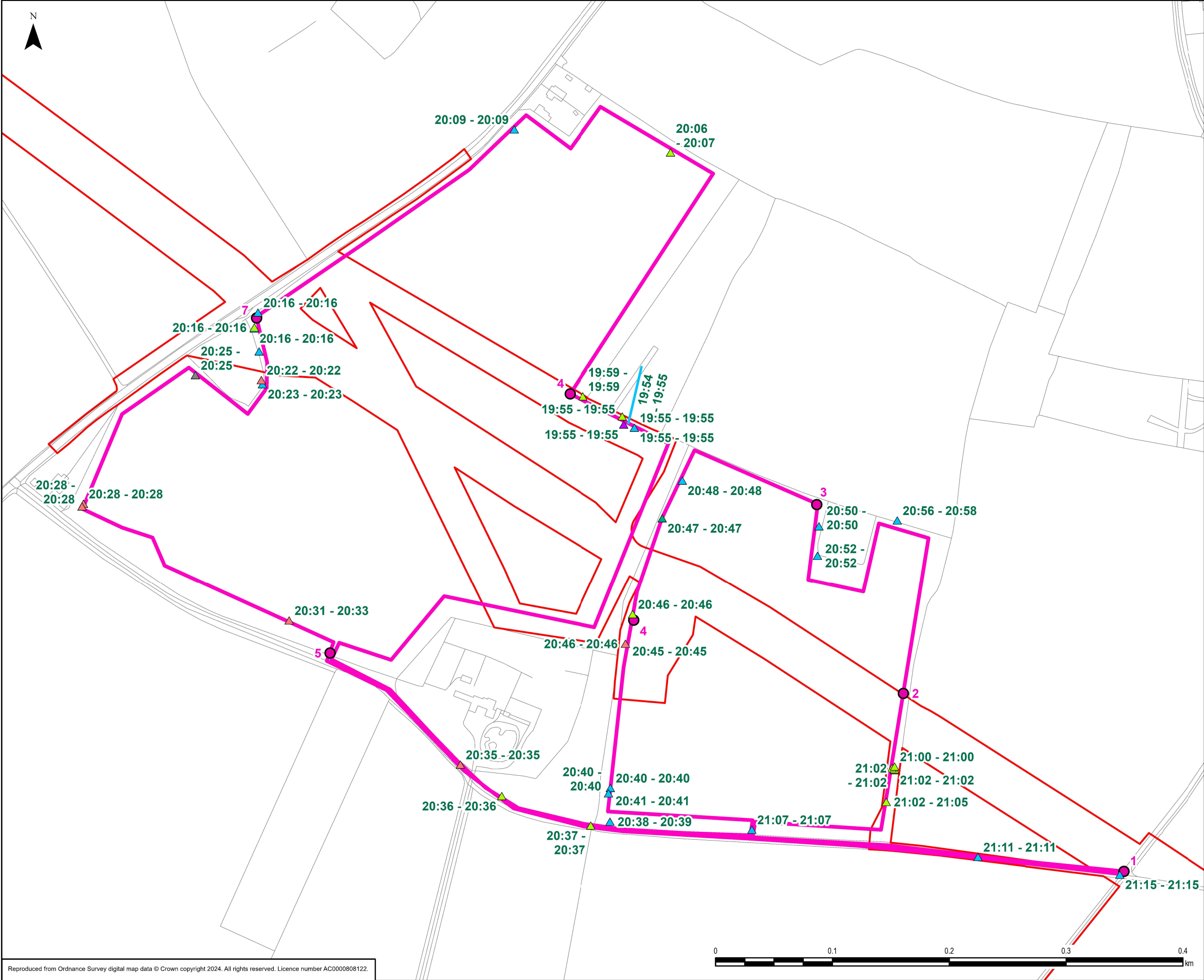

Legend

Suffolk Onshore Scheme Boundary

Transect 4 Point

Transect 4 Line

Bat Activity - Point

Common pipistrelle

Leisler's Bat

Myotis species

Pipistrelle species

Serotine

Soprano pipistrelle

Bat Activity - Line

Common pipistrelle

0	21/01/2025	ENVIRONMENTAL STATEMENT	EB	DF	RW
Rev	Date	Description	GIS	Chk	App
nationalgrid					
Scheme: SEA LINK					
Document Title: SUFFOLK NIGHTTIME BAT WALKOVER - AUGUST 2023 TRANSECT 4					
Creator: EB	Date: 21/01/2025	Checker: DF	Date: 21/01/2025	Approver: RW	Date: 21/01/2025
Document Ref: FIGURE 6.4.2.2.1.2	Scale: 1:3,000	Format: A3	Sheets: 1	Rev: 0	

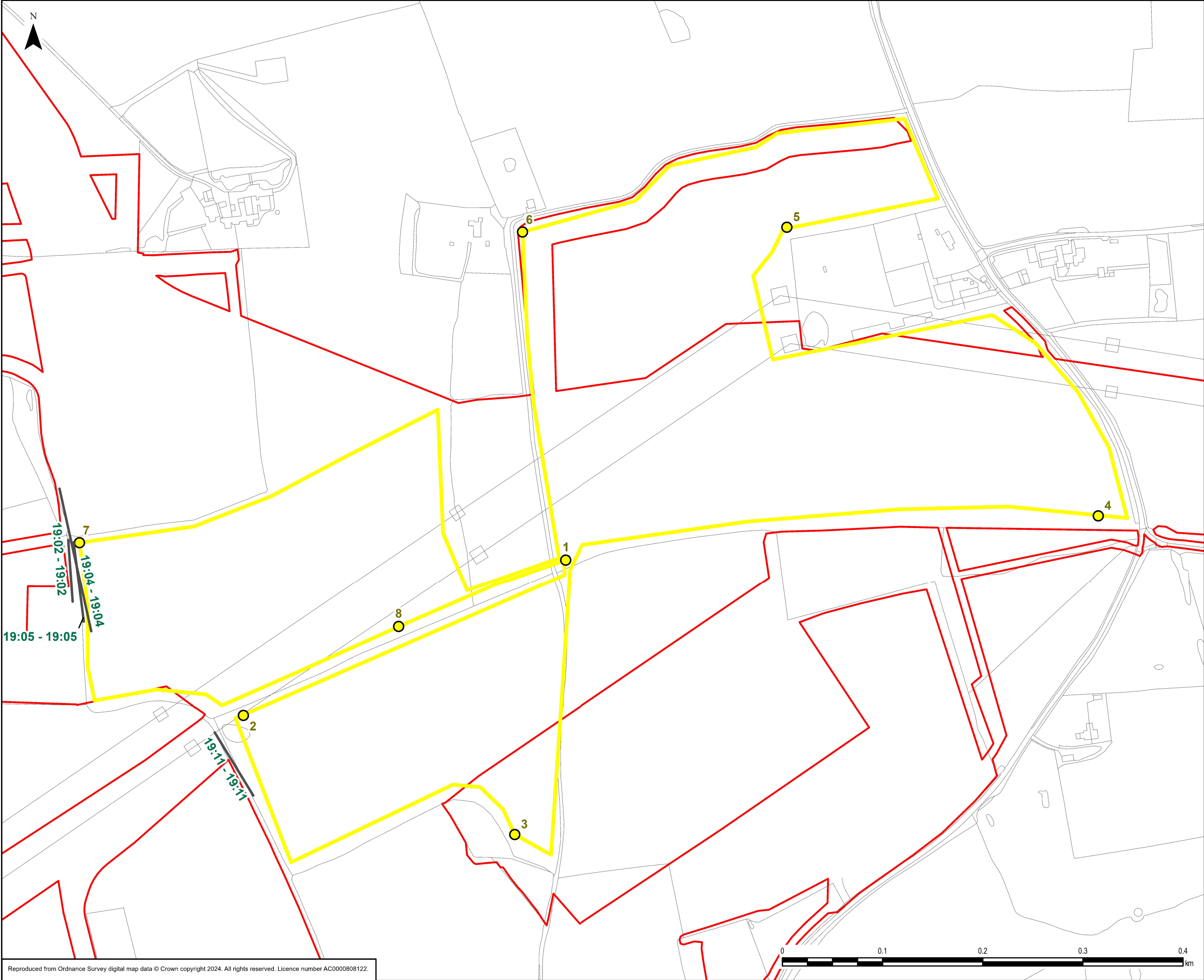

Legend

Suffolk Onshore Scheme Boundary

Transect 6 Point

Transect 6 Line

Bat Activity - Line

Bat species

0	21/01/2025	ENVIRONMENTAL STATEMENT	EB	DF	RW
Rev	Date	Description	GIS	Chk	App
nationalgrid					
Scheme: SEA LINK					
Document Title: SUFFOLK NIGHTTIME BAT WALKOVER - AUGUST 2023 TRANSECT 6					
Creator: EB	Date: 21/01/2025	Checker: DF	Date: 21/01/2025	Approver: RW	Date: 21/01/2025
Document Ref: FIGURE 6.4.2.2.1.2	Scale: 1:3,500	Format: A3	Sheets: 1	Rev: 0	

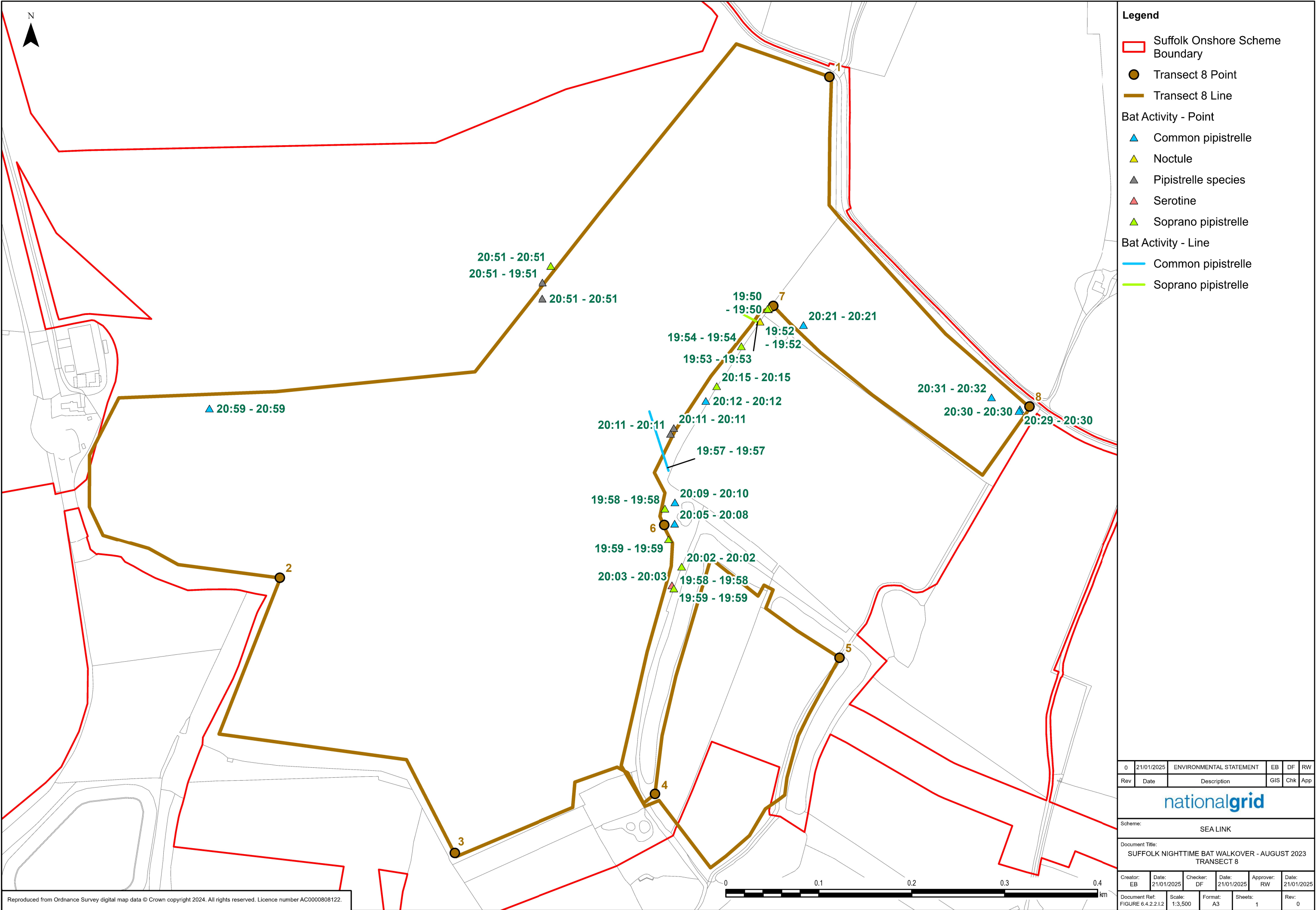

Reproduced from Ordnance Survey digital map data © Crown copyright 2024. All rights reserved. Licence number AC0000808122.

0	21/01/2025	ENVIRONMENTAL STATEMENT	EB	DF	RW
Rev	Date	Description	GIS	Chk	App
nationalgrid					
Scheme: SEA LINK					
Document Title: SUFFOLK NIGHTTIME BAT WALKOVER - AUGUST 2023 TRANSECT 8					
Creator: EB	Date: 21/01/2025	Checker: DF	Date: 21/01/2025	Approver: RW	Date: 21/01/2025
Document Ref: FIGURE 6.4.2.2.1.2	Scale: 1:3,500	Format: A3	Sheets: 1	Rev: 0	

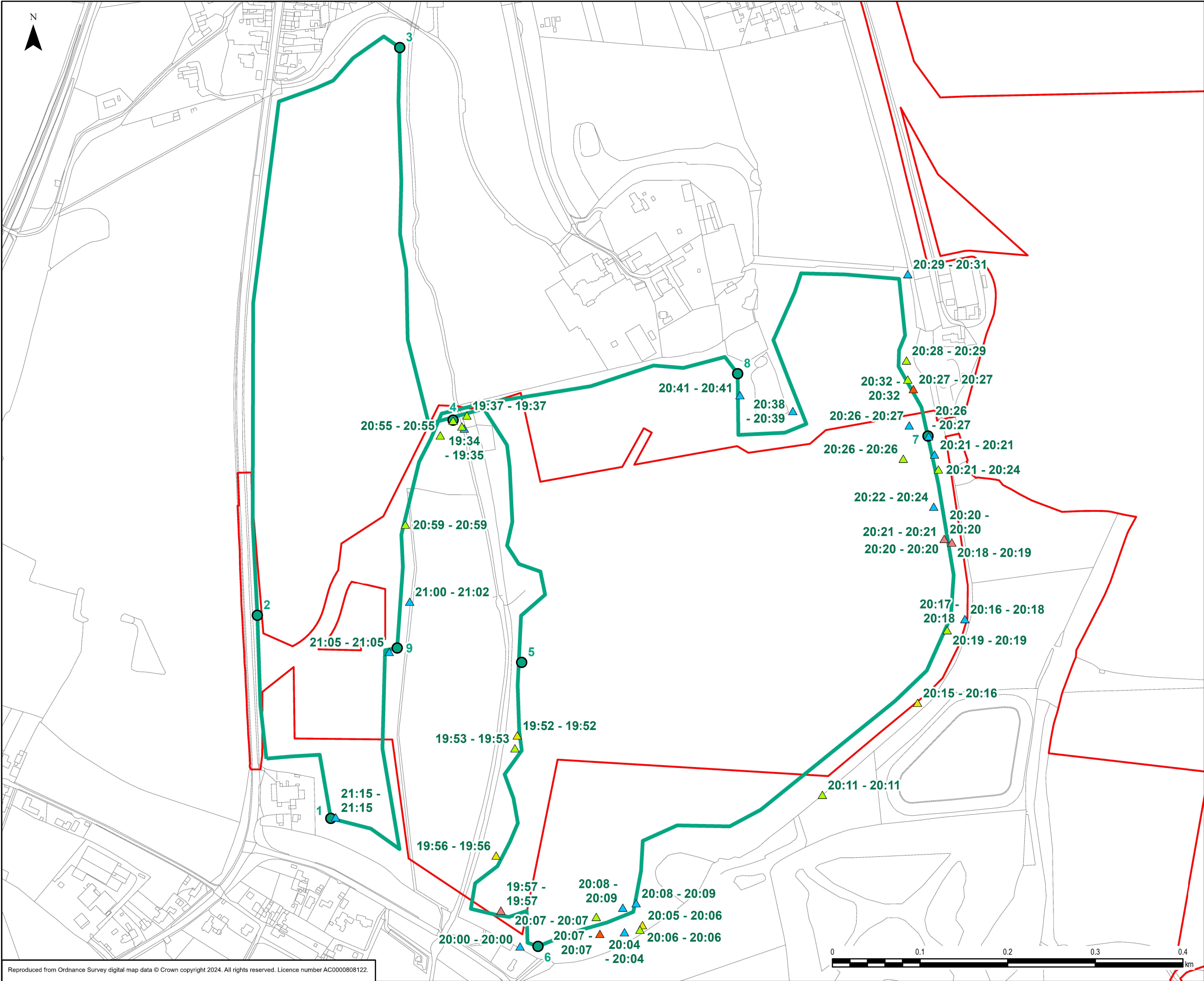

- Legend**
- Suffolk Onshore Scheme Boundary
 - Transect 9 Point
 - Transect 9 Line
 - Bat Activity - Point
 - Barbastelle
 - Common pipistrelle
 - Noctule
 - Pipistrelle species
 - Serotine
 - Soprano pipistrelle

0	28/01/2025	ENVIRONMENTAL STATEMENT	EB	DF	RW
Rev	Date	Description	GIS	Chk	App
nationalgrid					
Scheme: SEA LINK					
Document Title: SUFFOLK NIGHTTIME BAT WALKOVER - AUGUST 2023 TRANSECT 9					
Creator: EB	Date: 28/01/2025	Checker: DF	Date: 28/01/2025	Approver: RW	Date: 28/01/2025
Document Ref: FIGURE 6.4.2.2.1.2	Scale: 1:4,000	Format: A3	Sheets: 1	Rev: 0	

National Grid plc
National Grid House,
Warwick Technology Park,
Gallows Hill, Warwick.
CV34 6DA United Kingdom

Registered in England and Wales
No. 4031152
nationalgrid.com